

REVISIONS		
DATE	NAME	NO.
2-2-89	WARREN D. SKRABLE	13457
12-30-91	RAIMONDI ASSOC.	
11-3-93	WARREN D. SKRABLE	13457
9-11-94	WARREN D. SKRABLE	13457
11-18-96	WARREN D. SKRABLE	13457
4-20-01	JOHN C. RICHARDSON JR.	20789
4-15-03	JOHN C. RICHARDSON JR.	20789
12-31-03	JOHN C. RICHARDSON JR.	20789

BOROUGH OF NEW MILFORD

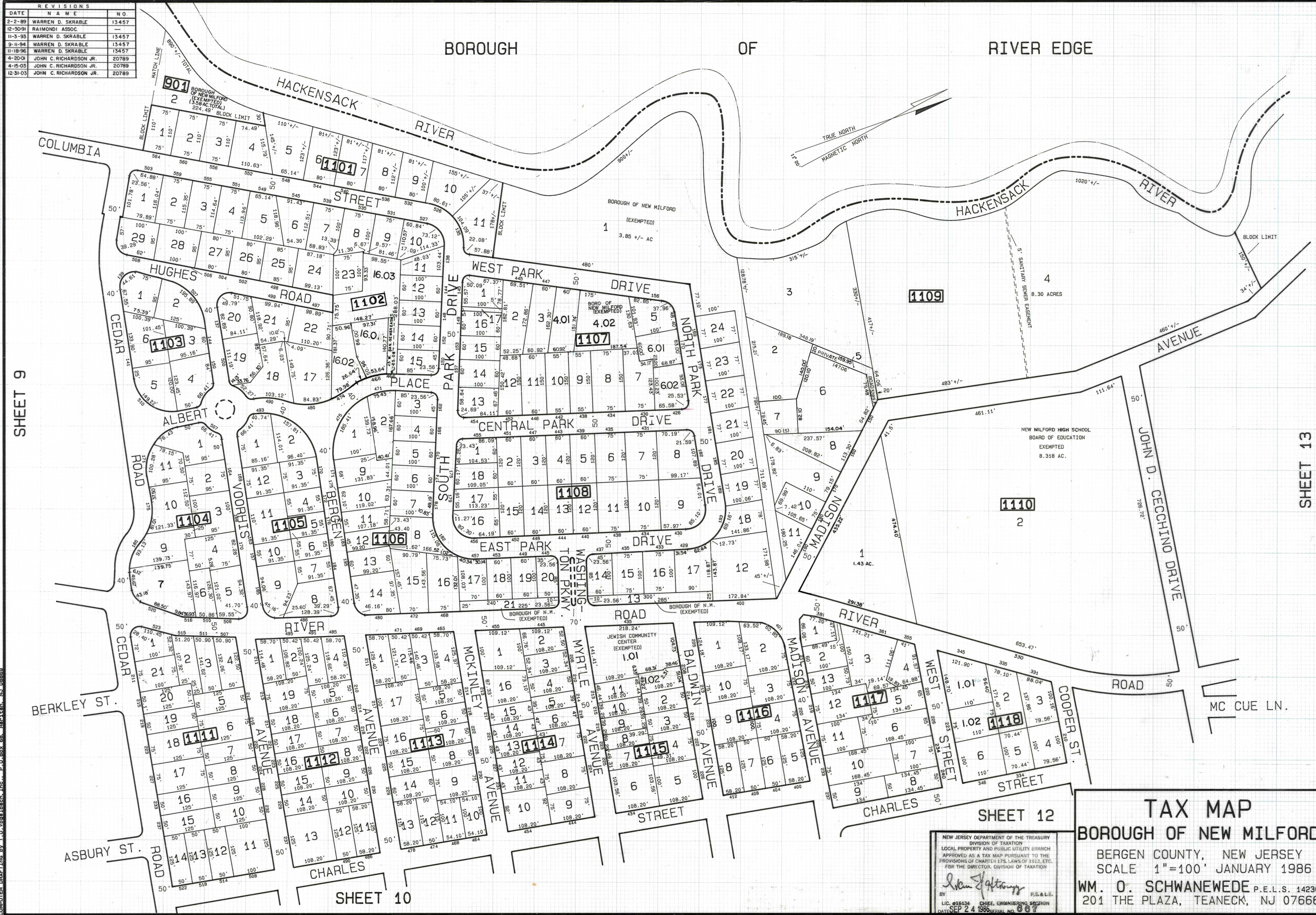

SHEET 9

SHEET 13

SHEET 12

SHEET 10

NEW JERSEY DEPARTMENT OF THE TREASURY
 DIVISION OF TAXATION
 LOCAL PROPERTY AND PUBLIC UTILITY BRANCH
 APPROVED AS A TAX MAP PURSUANT TO THE
 PROVISIONS OF CHAPTER 175, LAWS OF 1912, ETC.
 FOR THE DIRECTOR, DIVISION OF TAXATION

John J. Anthony
 BY: P.E. & L.S.
 LIC. #18434 CHIEF ENGINEERING DESIGN
 DATE: SEP 24 1986 SERIAL NO. 067

TAX MAP
BOROUGH OF NEW MILFORD
 BERGEN COUNTY, NEW JERSEY
 SCALE 1"=100' JANUARY 1986
WM. O. SCHWANEWEDE P.E.L.S. 14230
 201 THE PLAZA, TEANECK, NJ 07666

COMPUTER DRAFTING BY T.O. VORPACH, INC., P.O. BOX 68, BRICKTON, N.J. 08829