

DATE	NAME	NO.
12-30-91	RAIMONDI ASSOC.	-
4-20-01	JOHN C. RICHARDSON JR.	20789
12-31-03	JOHN C. RICHARDSON JR.	20789

SHEET 12

SHEET 11

SHEET 9

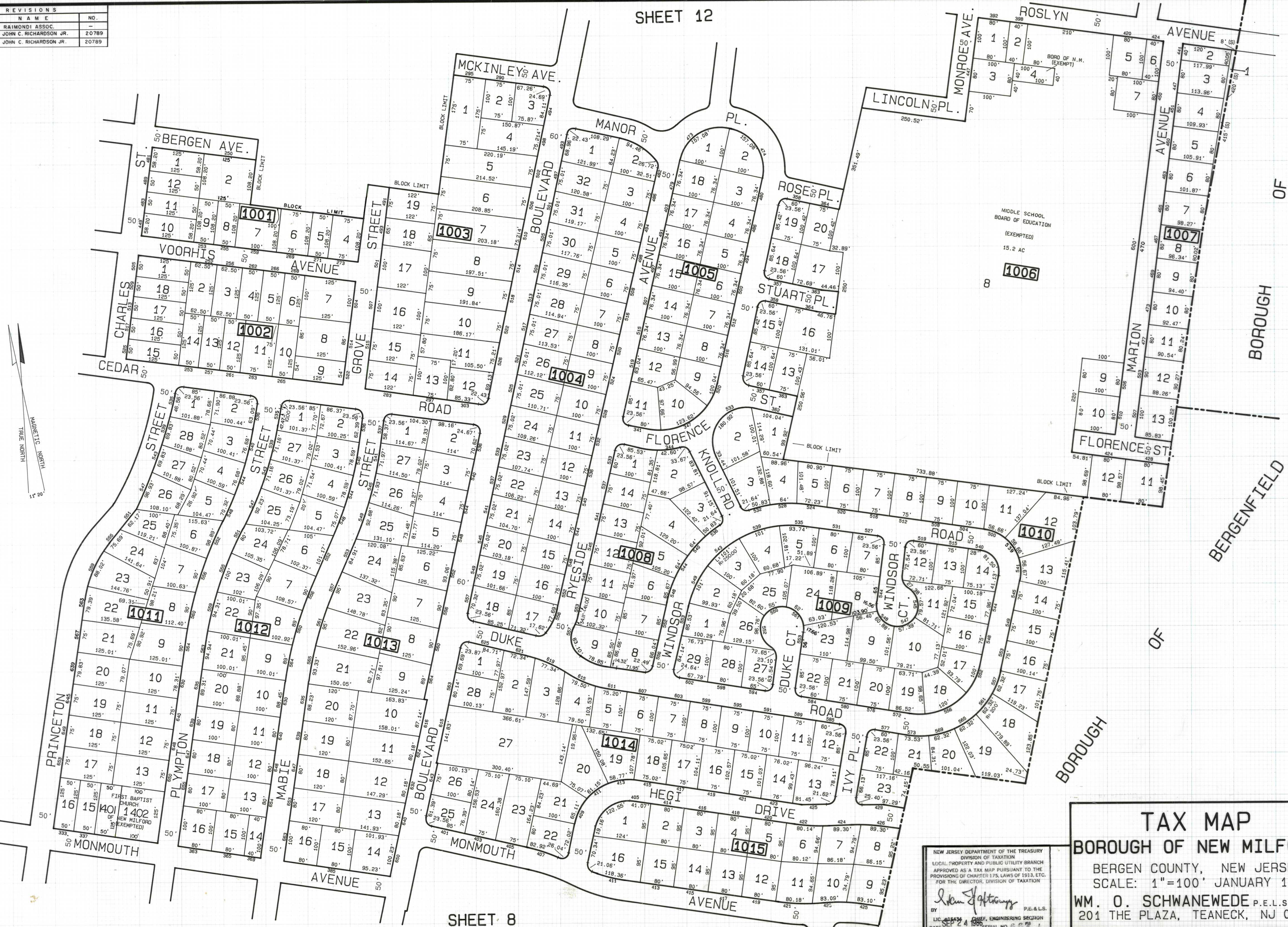
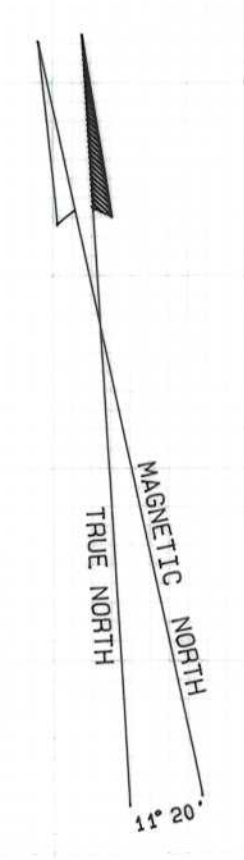

TAX MAP
BOROUGH OF NEW MILFORD
 BERGEN COUNTY, NEW JERSEY
 SCALE: 1"=100' JANUARY 1986
 WM. O. SCHWANWEDE P.E.L.S. 14230
 201 THE PLAZA, TEANECK, NJ 07666

NEW JERSEY DEPARTMENT OF THE TREASURY
 DIVISION OF TAXATION
 LOCAL PROPERTY AND PUBLIC UTILITY BRANCH
 APPROVED AS A TAX MAP PURSUANT TO THE
 PROVISIONS OF CHAPTER 175, LAWS OF 1933, ETC.
 FOR THE DIRECTOR, DIVISION OF TAXATION
William J. Hoffmann
 BY: P.E. & L.S.
 LIC. 12434 CHIEF, ENGINEERING SECTION
 DATE: SEP 24 1986 SERIAL NO. 6

SHEET 8